

ISO/TS16949 REGISTERED
TB-038 • January 2009

Attention to all drivers using the 7000CC! Exercise care when coupling & uncoupling to prevent Clean Connect greaseless insert damage.

This vehicle is equipped with a Fontaine® 7000CC Clean Connect fifth wheel, exercise care when coupling & uncoupling.

The greaseless inserts are designed to handle the rigors of normal use, they are not designed to handle direct contact from the trailer kingpin or a damaged trailer bolster plate (i.e. jagged, sharp). Any contact to the surface of the greaseless inserts from the items listed will cause damage. When used properly, this environmental friendly technology can provide your company with lower operating costs, so use care when coupling your truck. This will ensure that your company receives the benefits of the Fontaine 7000CC Clean Connect fifth wheel.

No-Slack® 7000CC

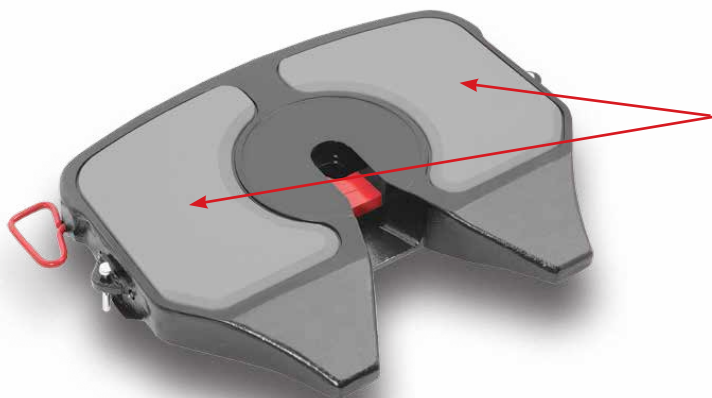

The Clean Connect is supplied with two replaceable greaseless wear pads.

Placing the trailer kingpin onto the surface of these pads will cause irreversible damage.

**In the event that a pad is damaged,
a replacement can be ordered.**

Left Side Plate	CC-PLATES-L
Right Side Plate	CC-PLATES-R
Both Plates (L&R)	CC-PLATES